

PROPOSED PERIMETER WALL, MARKET SHEDS, TOILETS AND LEVELLING OF LAARE FRESH PRODUCE MARKET IN IGEMBE NORTH SUB-COUNTY

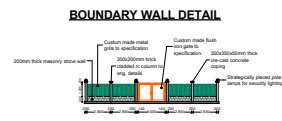
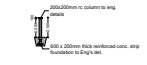
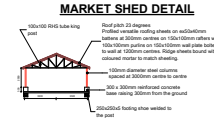

NOTES

1. THIS DRAWING SHOULD BE READ IN CONJUNCTION WITH STRUCTURAL DRAWING AND ANY OTHER RELEVANT DETAILED DRAWING
2. ALL DIMENSIONS ARE IN MILLIMETRES UNLESS OTHERWISE STATED
3. ALL FOUNDATION DEPTH TO BE DETERMINED ON SITE AS PER SOIL TYPES
4. ALL STEEL REINFORCEMENT TO STRUCTURAL ENGINEER'S DETAIL
5. CONTRACTOR SHALL READ AND VERIFY THE DIMENSIONS BEFORE STARTING ANY WORK
6. ALL DRAINAGE/PLUMBING WORKS TO THE M.O.H STANDARDS AND SATISFACTION

PROJECT
PROPOSED PERIMETER WALL, MARKET SHEDS, TOILETS AND LEVELLING OF LAARE FRESH PRODUCE MARKET

CLIENT
 DEPARTMENT OF CO-OPERATIVES,
 MERU COUNTY GOVERNMENT
 P.O. BOX 120-60200,
 MERU

Scale
 1:100

DRAWING TITLE
FLOOR LAYOUT PLAN, SECTION & ELEVATION

Drawn: L.N.M Signature..... Date.....

Checked: Lornah N. Signature..... Date.....

Client's Signature Date.....

Date: NOVEMBER, 2016