

**PROPOSED PERIMETER WALL, MARKET SHEDS, LEVELLING  
AND TOILETS AT NGUNDUNE MARKET**

**LAYOUT PLAN**

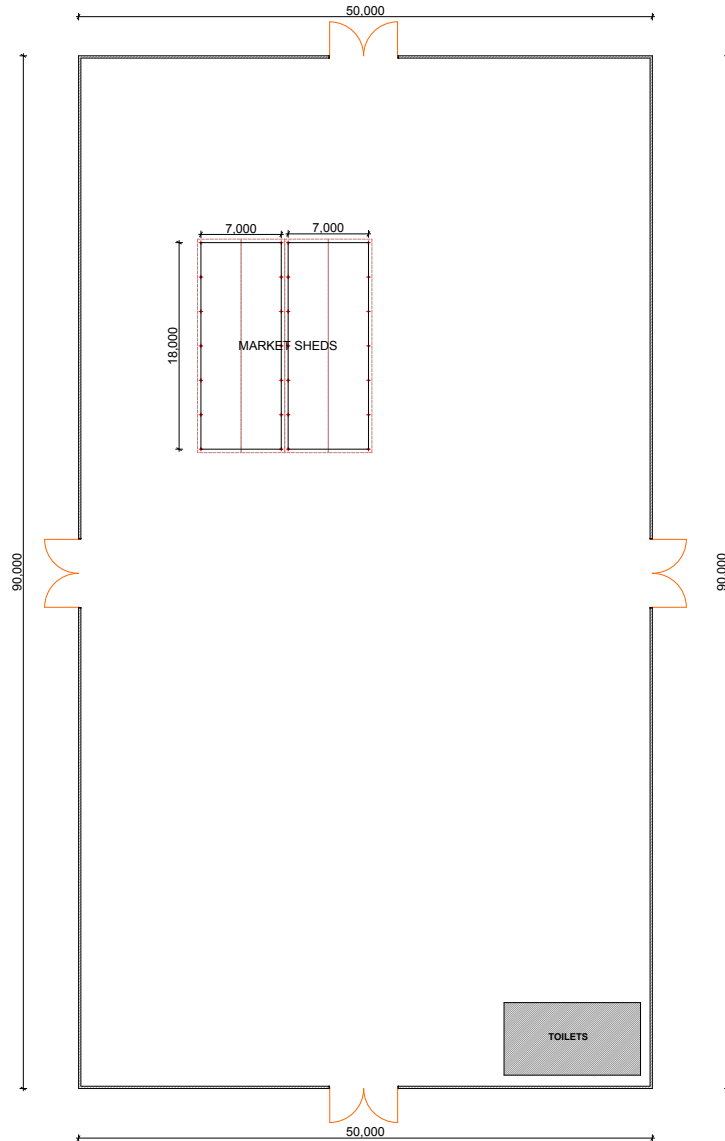

**BOUNDARY WALL DETAIL**

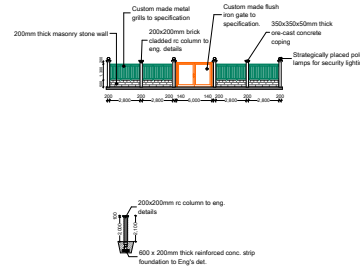

**MARKET SHED DETAIL**

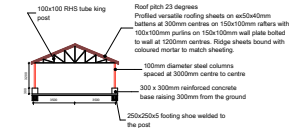

**NOTES**

1. THIS DRAWING SHOULD BE READ IN CONJUNCTION WITH STRUCTURAL DRAWING AND ANY OTHER RELEVANT DETAILED DRAWING
2. ALL DIMENSIONS ARE IN MILLIMETRES UNLESS OTHERWISE STATED
3. ALL FOUNDATION DEPTH TO BE DETERMINED ON SITE AS PER SOIL TYPES
4. ALL STEEL REINFORCEMENT TO STRUCTURAL ENGINEER'S DETAIL
5. CONTRACTOR SHALL READ AND VERIFY THE DIMENSIONS BEFORE STARTING ANY WORK
6. ALL DRAINAGE/PLUMBING WORKS TO THE M.OH STANDARDS AND SATISFACTION

**REVISIONS**

**PROJECT**

**PROPOSED PERIMETER WALL,  
MARKET SHEDS, LEVELLING AND  
TOILETS AT NGUNDUNE MARKET**

**CLIENT**

**DEPARTMENT OF CO-OPERATIVES,  
MERU COUNTY GOVERNMENT  
P.O.BOX 120-60200,  
MERU**

**Scale  
1:100**

**DRAWING TITLE**

**FLOOR LAYOUT PLAN  
& DETAILS**

**Drawn: L.N.M ..... Signature..... Date.....**

**Checked: Lornah N. Signature..... Date.....**

**Client's Signature ..... Date.....**

**Date: JANUARY, 2017**